

# Stair nosing installation guide



## Before you start



### **Follow building code and relevant regulations**

Research local building code to ensure you're following regulations.



### **Triple check you've got the correct length and fitting**

Some things may have changed since the drawings were developed. Ensure the nosing fits perfectly along the edge of the stair. Also, ensure the fitting shape works with your stair type. L shaped nosing's should work for 90-degree angle stairs, the nosings should be able to lie flat.



### **Clean! Clean! Clean! (especially after drilling)**

Thoroughly clean the stairs to remove dust and make the adhesive most effective.

Once your profile is installed you can proceed to adhere the insert.

## Insert install

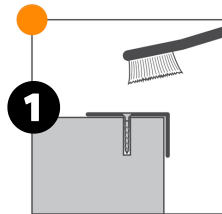

Ensure that all surfaces are thoroughly clean.

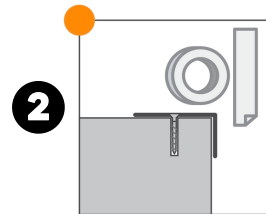

Remove double sided tape.

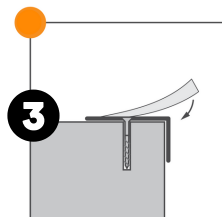

Push into fixing (if using rubber, cup while slowly removing tape.)

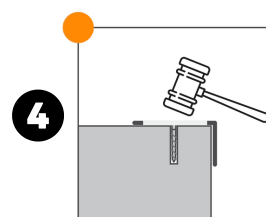

Tap into place with mallet (if using rubber, use knife to cut any excess once insert is inserted.)



**TOP TIP:** Do not stretch the rubber insert. If stretched, it may return to original size over time.

## Care and Maintenance

### Regular cleaning



If your stairs do not get heavy foot traffic, it is recommended that you clean the stair nosings on a weekly basis. But, if it is a commercial building and gets heavy foot traffic, it is better to clean them more often to ensure there is no dirt or grease build up. You can clean the inserts with a mild detergent diluted in water and carefully wipe the stair nosings with a damp cloth, followed by wiping it dry with a clean cloth.

### Check for damage



Regularly check your stairs and stair nosings for signs of wear and damage. Stair nosings can be replaced as wear and tear starts to show, ensuring the safety standards in your environment are kept very high and this way you will save on large repair costs.



# Installation methods:

## Mechanical fixings with adhesive

Recommended for most installations. For robust and long lasting results.

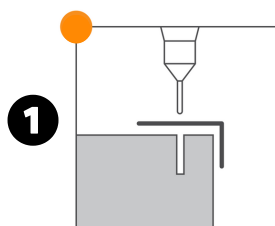

Using the pre-drilled stair nosings as templates, mark the hole locations on the step by spotting with a drill. We suggest fixings approximately 300mm apart, alternating between the middle and back of the profile.

Remove the nosing and drill the holes into the step (stair nosings are supplied with fasteners - please check application and fasteners first).

If installing in delicate substrates, use specialised drilling equipment.



**TOP TIP:** In the case of tiled or masonry stairs, extreme care must be taken to ensure the step edge does not crack or shatter. In the case of timber or metal stairs, drilling a pilot hole with a smaller drill bit may be necessary.

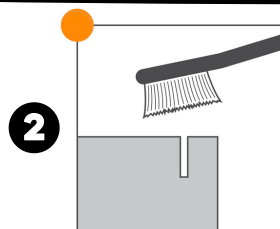

In concrete, drill 6mm holes to allow for plugs.

Once the holes have been drilled, ensure all surfaces are thoroughly clean and free of dust.

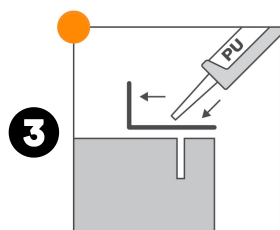

Insert plugs into holes and apply structural adhesive (e.g. CA290 adhesive) to the underside of stair nosing profile (1 to 2 beads in a straight line to the riser edge and beside screw holes along the entire length) to cushion any step variance and to prevent the nosing from rocking.

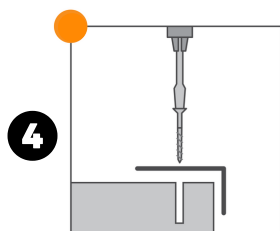

Place nosing down onto step and firmly screw into place using the screws provided. The stair nosings must be firm and the fasteners flush.

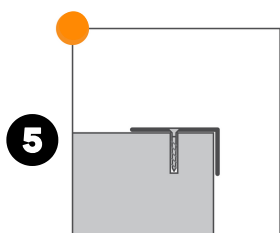

Once the stair nosing base has been securely and satisfactorily installed, the slip resistant inserts can be fitted into place. Refer to the specific method, which applies to your application. (See back page)



**TOP TIP:** We strongly recommend allowing approx. 50mm gap from each end of the stair nosing profile to the stair stringer/walls, and also expansion gaps at approx. 3 metre intervals.

# Installation methods:

## Mechanical fixings

Recommended for carpeted surfaces and affordability

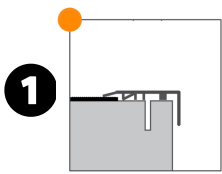

For best results, remove both the carpet and the underlay from the step edge and install the stair nosing with the rear gripper section overlapping the carpet. A packer may be required to raise the carpet thickness.

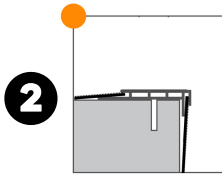

Where the stair nosing is designed to be installed over broadloom type carpet, use the pre-drilled stair nosing as a template to mark the fixing positions onto the carpet, then punch holes out of the carpet using a suitable wad punch.

Where installing a nosing to suit carpet tiles (i.e. Tredfx PBD106), trim back the tiles to suit the width of the profile.

In concrete, drill 6mm holes to allow for plugs.

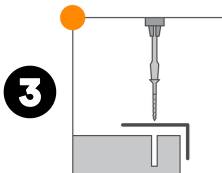

Mechanically fix stair nosings into substrate following each prescribed procedure for either concrete or timber stairs.

Once the stair nosing base has been securely and satisfactorily installed, the slip-resistant inserts can be fitted into place. Refer to the specific method, which applies to your application.

NOTE: It is very important that they are securely fixed down, as carpet can compress over time, loosening the fasteners.

## Adhesive fixing

Suitable for quick installs on other solid surfaces.

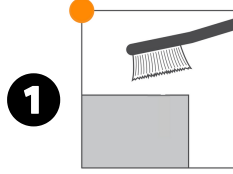

Ensure that all surfaces are thoroughly clean.

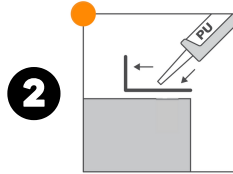

Apply CA290 adhesive to the underside of stair nosing profile (at least 2 beads in a straight line along the entire length including the riser edge) to cushion any variance and to prevent nosing from rocking.

**We'll give you a Caulking gun for free with the purchase of 12 of more tubes.**

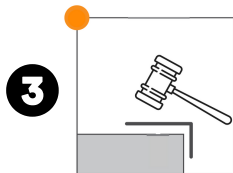

Place nosing down onto step and firmly tap with a rubber mallet to ensure good adhesion and to displace any trapped air.

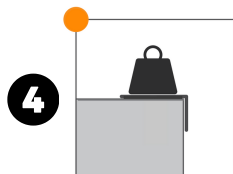

The stair nosings must be a firm, flush finish. Ensure the stair nosings are securely held to the step edge using tape or weights and are free of all traffic until the adhesive has achieved its full cure (allow 24 hours).

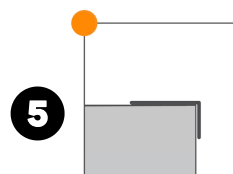

Once the stair nosing base has been securely and satisfactorily installed, the slip-resistant inserts can be fitted into place.

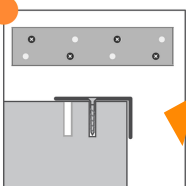

**TOP TIP:** When setting up nosings, drill in alternate holes, or in one screw per pair of holes. This will reduce the rocking of the nosing once applied.